

# Régleur de débit mâle cylindrique à molette - Bidirectionnel - RPM

## BG



### Filetage mâle BSPP

G 1/8

### Pour tube Ø ext. (mm)

4

### Pression d'utilisation

0 à 10 bar

### Température

0°C à + 60°C

### Matière

Polymère et laiton nickelé

## Description

| Référence  | Filetage mâle BSPP | Pour tube Ø ext. (mm) |
|------------|--------------------|-----------------------|
| RPM BG0400 | G 1/8              | 4                     |
| RPM BG0401 | G 1/4              | 4                     |
| RPM BG0600 | G 1/8              | 6                     |
| RPM BG0601 | G 1/4              | 6                     |
| RPM BG0602 | G 3/8              | 6                     |
| RPM BG0603 | G 1/2              | 6                     |

| Référence  | Filetage mâle BSPP | Pour tube Ø ext. (mm) |
|------------|--------------------|-----------------------|
| RPM BG0800 | G 1/8              | 8                     |
| RPM BG0801 | G 1/4              | 8                     |
| RPM BG0802 | G 3/8              | 8                     |
| RPM BG0803 | G 1/2              | 8                     |
| RPM BG1000 | G 1/8              | 10                    |
| RPM BG1001 | G 1/4              | 10                    |
| RPM BG1002 | G 3/8              | 10                    |
| RPM BG1003 | G 1/2              | 10                    |
| RPM BG1201 | G 1/4              | 12                    |
| RPM BG1202 | G 3/8              | 12                    |
| RPM BG1203 | G 1/2              | 12                    |

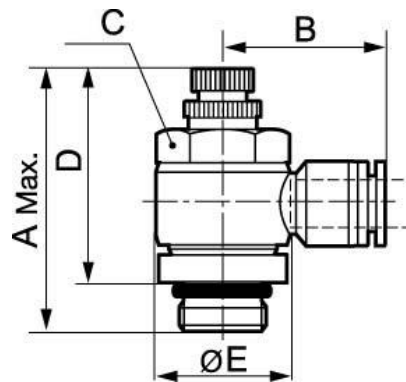

### Dimensions

| Référence  | A mm | B mm | C mm | D mm | E mm |
|------------|------|------|------|------|------|
| RPM BG0400 | 42   | 21.8 | 10   | 36   | 14.5 |
| RPM BG0401 | 46   | 24   | 14   | 39.5 | 18.2 |
| RPM BG0600 | 42   | 23   | 10   | 36   | 14.5 |
| RPM BG0601 | 46   | 25.5 | 14   | 39.5 | 18.2 |
| RPM BG0602 | 55   | 27.1 | 19   | 47.5 | 22   |
| RPM BG0603 | 61   | 30.1 | 24   | 52   | 27.4 |
| RPM BG0800 | 42   | 24.6 | 10   | 36   | 14.5 |
| RPM BG0801 | 46   | 26.8 | 14   | 39.5 | 18.2 |
| RPM BG0802 | 55   | 28.8 | 19   | 47.5 | 22   |
| RPM BG0803 | 61   | 30.5 | 24   | 52   | 27.4 |
| RPM BG1000 | 42   | 28.5 | 10   | 36   | 14.5 |
| RPM BG1001 | 46   | 31   | 14   | 39.5 | 18.2 |
| RPM BG1002 | 55   | 31   | 19   | 47.5 | 22   |
| RPM BG1003 | 61   | 34   | 24   | 52   | 27.4 |
| RPM BG1201 | 46   | 31.8 | 14   | 39.5 | 18.2 |
| RPM BG1202 | 55   | 34   | 19   | 47.5 | 22   |

| Référence         | A mm | B mm | C mm | D mm | E mm |
|-------------------|------|------|------|------|------|
| <b>RPM BG1203</b> | 61   | 35.8 | 24   | 52   | 27.4 |